

Aquafil Pulse Senior 1400B

Bottle Refill Station

SKU: AQ-PS1400B

Stainless steel, hygienic and user-friendly drinking water station with two bottle refill points. Customisable, vandal-resistant signage panels allow for educational or brand messages to be featured on the exterior.

Ideal for indoor and outdoor settings, including schools, universities, and other educational facilities.

Key Inclusions

- Two Water Bottle Refill Points (AS1428.2 1992 Compliant)
- Stainless Steel Construction
- Stainless Steel Buttons
- Custom Art Panels
- UV and Anti-Graffiti Protection

Customisation Options

- Filter
- Indoor or Outdoor Remote Chiller
- Water Meter
- Thermal Plumbing Insulation
- Frost Protection Device



Technical Details

Housing Frame	Stainless steel
Housing Unit	Anodised aluminium
Graphic Panels	Stainless steel
Filter Unit Position	Sub-micron or 5 micron
Filter Unit Working Pressure	10-125 psi (0.7-8.5 bar), non-shock
Water Supply Connections	1/2" supply line with 1/2" male BSP connection
Drainage	40mm PVC
Shipping Dimensions	150 x 40 x 50cm
Shipping Weight	50kg

Specification Text

Aquafil Indoor or Outdoor Drinking Water Station - 1405H x 346W x 359D. Complete with one drinking fountain and two AS1428.2 1992 compliant wheelchair-accessible bottle fillers on both sides. Full stainless-steel construction with UV and anti-graffiti protected interchangeable custom graphic panels. Optional filter, chiller, thermal plumbing insulation, frost protection device, installation and maintenance package. Product Code AQ-PS1400B.

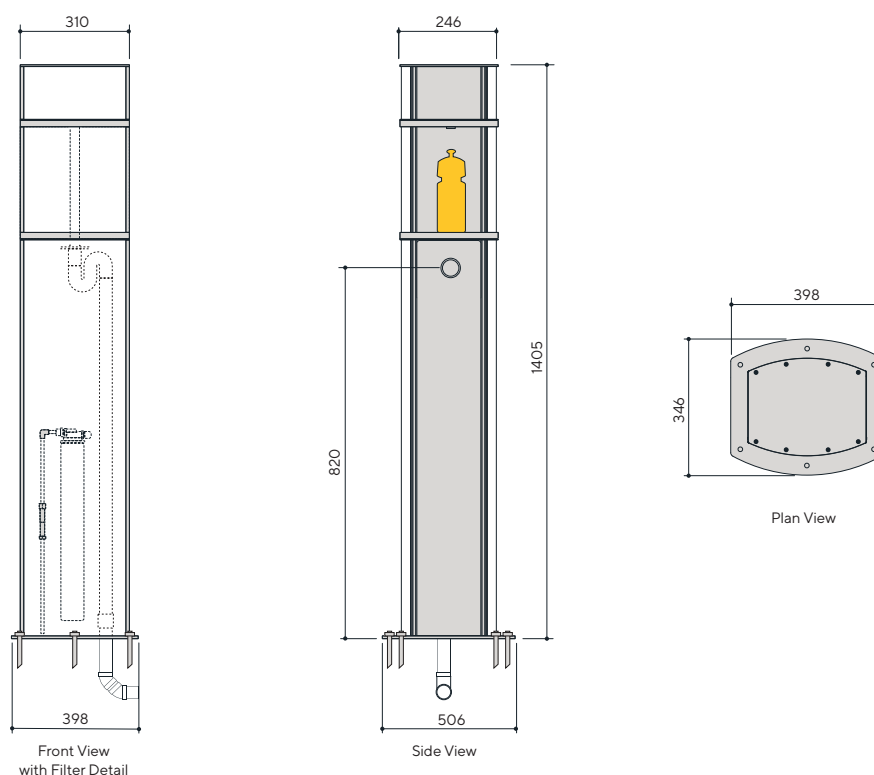

Visit civiq.com.au to access the most recent data, CAD files and installation instructions.

Aquafil Pulse Senior 1400B Semi-Portable

Bottle Refill Station

SKU: AQ-PS1400BF

Stainless steel, hygienic and user-friendly drinking water station with two bottle refill points. Customisable, vandal-resistant signage panels allow for educational or brand messages to be featured on the exterior.

Robust, sturdy, easy to store and economical, the station is ideal for schools, sports clubs and events venues.

Key Inclusions

- Two Water Bottle Refill Points (AS1428.2 1992 Compliant)
- Stainless Steel Construction
- Stainless Steel Buttons
- Custom Art Panels
- UV and Anti-Graffiti Protection
- Semi-Portable, Reconfigurable Design

Customisation Options

- Filter
- Indoor or Outdoor Remote Chiller
- Water Meter



Technical Details

Housing Frame	Stainless steel
Housing Unit	Anodised aluminium
Graphic Panels	Stainless steel
Filter Unit Position	Sub-micron or 5 micron
Filter Unit Working Pressure	10-125 psi (0.7-8.5 bar), non-shock
Water Supply Connections	1/2" inch water hose with quick connect non spill fittings 20mm and 15mm tap adaptors

Specification Text

Aquafil Semi-Portable Indoor or Outdoor Drinking Water Station - 1405H x 500W x 600D. Complete with two AS1428.2 1992 compliant wheelchair-accessible bottle fillers on both sides. Full stainless-steel construction with UV and anti-graffiti protected interchangeable custom graphic panels. Optional filter, chiller, and meter. Product Code AQ-PS1400BP.

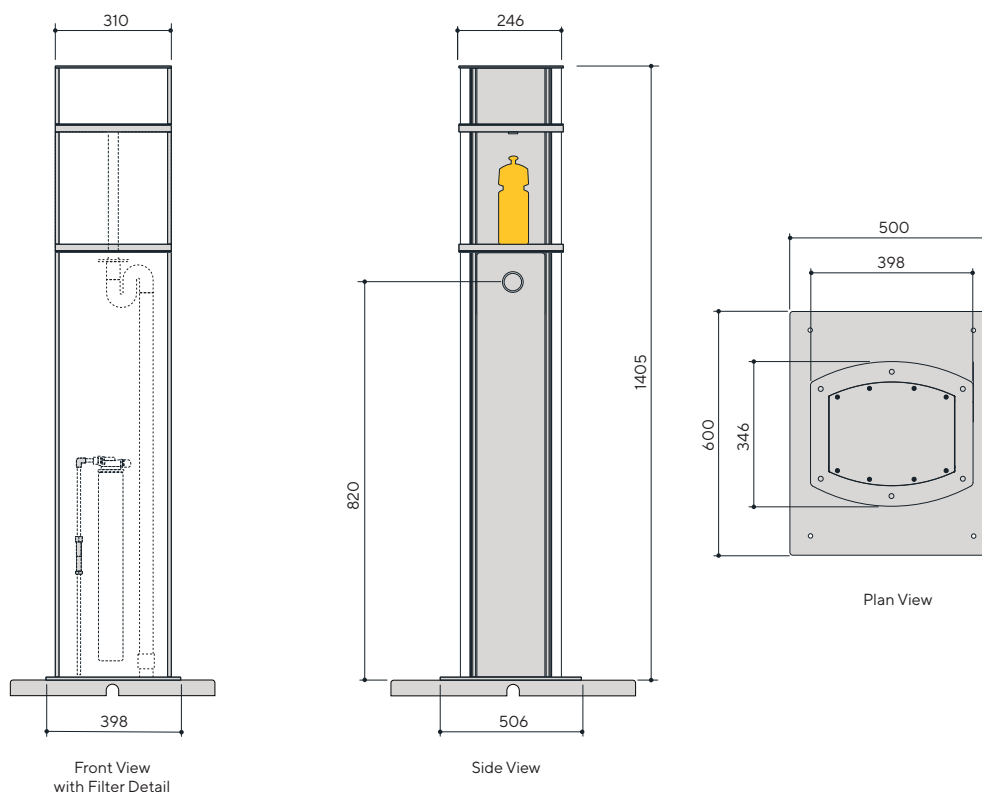

Visit civiq.com.au to access the most recent data, CAD files and installation instructions.